

**Technical specification**

Mounting torque: max. 25 Nm  
Ambient temperature: -40°C ... +125°C  
Media temperature: -40°C ... +125°C

**Type label description**

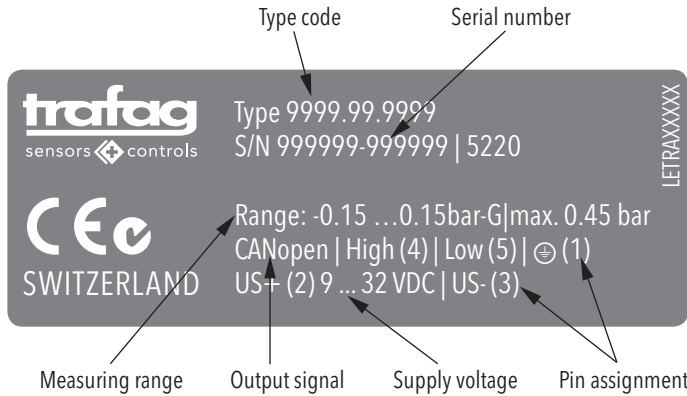

**Electrical connections**

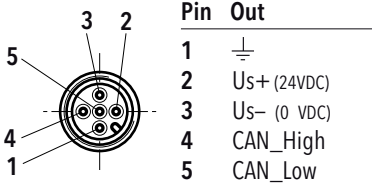

**CANopen-protocol**

Output signal: CAN BUS (ISO 118982)  
CANopen: DS-301 V4.0  
Device profile: DS 404-1 V1.2  
Baudrate:  
10 kbit/s  
20 kbit/s  
50 kbit/s  
125 kbit/s  
250 kbit/s  
500 kbit/s  
800 kbit/s  
1 Mbit/s  
Automatic bit rate detection  
Node ID: 1 ... 127

## Electrical connection

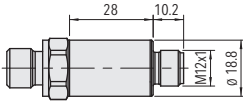

8271.XX.XXXX**35**XX.XX

## Pressure connections

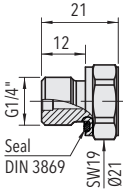

8271.XX.XX**17**XX

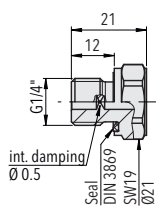

8271.XX.XX**15**XX

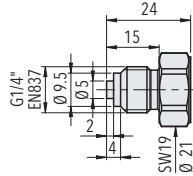

8271.XX.XX**53**XX

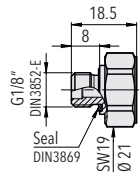

8271.XX.XX**54**XX

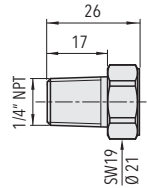

8271.XX.XX**30**XX

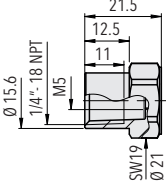

8271.XX.XX**13**XX

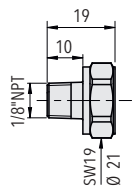

8271.XX.XX**43**XX

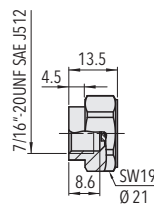

8271.XX.XX**24**XX

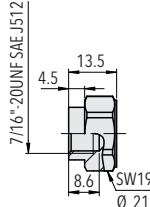

8271.XX.XX**44**XX

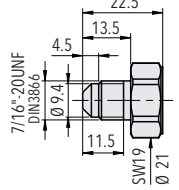

8271.XX.XX**18**XX

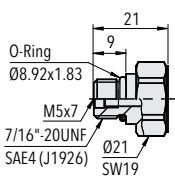

8271.XX.XX**42**XX

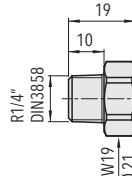

8271.XX.XX**19**XX

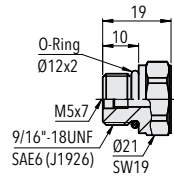

8271.XX.XX**61**XX

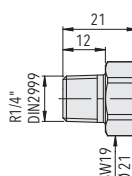

8271.XX.XX**20**XX

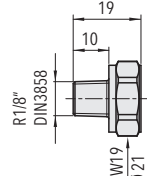

8271.XX.XX**16**XX

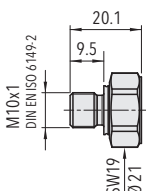

8271.XX.XX**32**XX

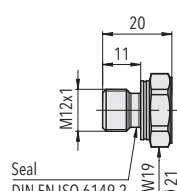

8271.XX.XX**64**XX

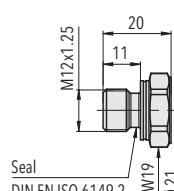

8271.XX.XX**65**XX

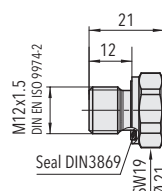

8271.XX.XX**49**XX

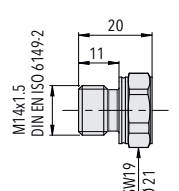

8271.XX.XX**31**XX